

LUG TYPE BUTTERFLY VALVE ANSI FLANGED

Model : ARV-112LT(A)

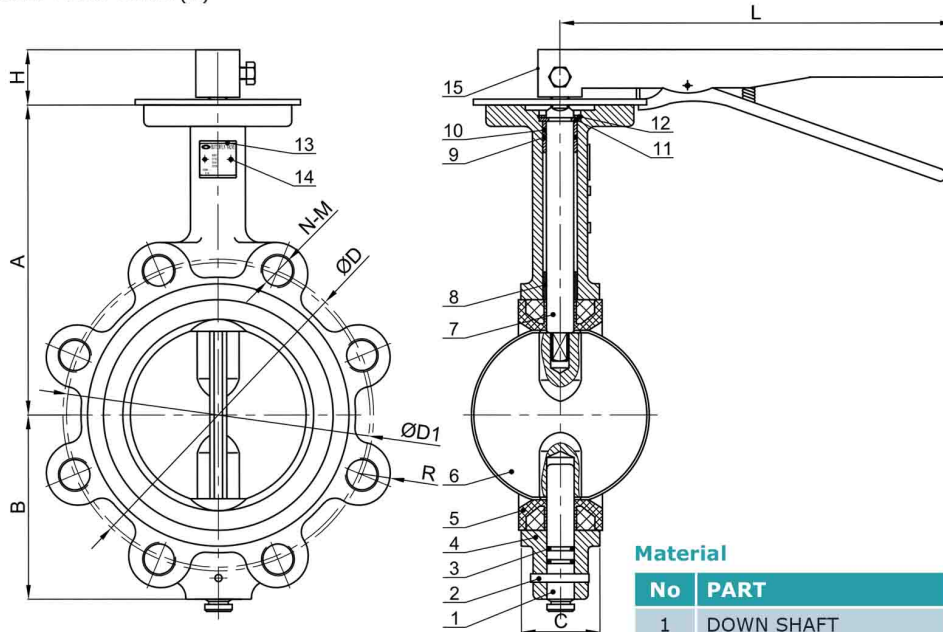

Design Standard

Design Standard	EN 593
Face to Face	EN 558
Flange Connection	ANSI 150
Test Standard	EN 12266-1

Hydrostatic Test

Pressure Rating	PN 10 / PN 16
Shell Test Pressure	1.5 / 2.4 Mpa
Seal Test Pressure	1.1 / 1.76 Mpa
Suitable Temperature	-20 to 180°C (PTFE)

Material

No	PART	MATERIAL
1	DOWN SHAFT	SS 316
2	LOCK PIN	SS 316
3	DOWN O-RING	VITON
4	BODY	CF8
5	SEAT	PTFE
6	DISC	CF8
7	UPPER SHAFT	SS 316
8	BUSHING (LONG)	PTFE
9	O-RING	VITON
10	BUSHING (SHORT)	PTFE
11	BESECT RING	SS 416
12	KEEPING RING	SPRING STEEL
13	NAME PLATE	ALUMINIUM
14	RIVET	ALUMINIUM
15	HAND LEVER	STAINLESS STEEL

Dimension in mm

DN	NPS	A	B	C	ØD	N-M	ØD1	R	H	L	
50	2"	156	80	42.04	Ø120.6	4-5/8"	10UNC	Ø125	15	24	240
65	2.5"	162	89	45.68	Ø139.7	4-5/8"	10UNC	Ø145	17	24	240
80	3"	170	95	45.21	Ø152.4	4-5/8"	10UNC	Ø152.4	15	24	240
100	4"	185	114	52.07	Ø190.5	8-5/8"	10UNC	Ø190.5	18	28	260
125	5"	207	127	55.36	Ø215.9	8-3/4"	10UNC	Ø215.9	22	32	267
150	6"	216	139	55.75	Ø241.3	8-3/4"	10UNC	Ø241.3	22	32	267
200	8"	256	175	60.58	Ø298.4	8-3/4"	10UNC	Ø298.4	22	34	355
250	10"	248	203	67.63	Ø361.9	12-7/8"	9UNC	Ø361.9	25	34	355
300	12"	280	242	76.9	Ø431.8	12-7/8"	9UNC	Ø431.8	23	34	355

The contents of this literature are for informative purposes only. Arita is not responsible for suitability or compatibility of these products in relation to system requirement. For specific requirements, consult Arita or its distributors. Arita reserves the right to change or modify product design without prior notice.

LUG TYPE BUTTERFLY VALVE ANSI FLANGED

Model : ARV-112LT(A)

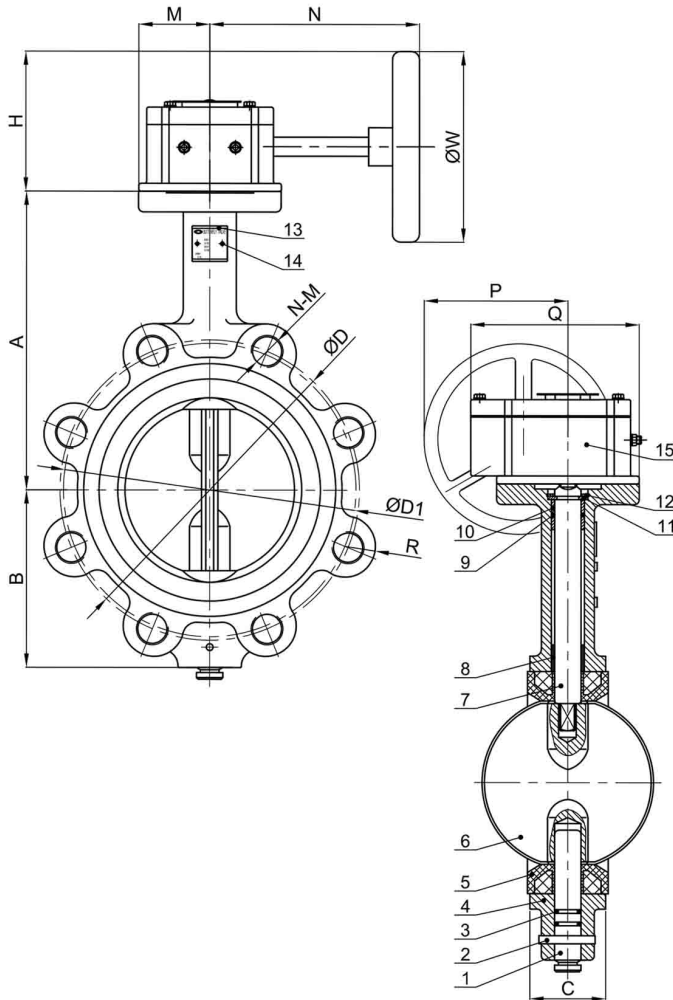

Design Standard

Design Standard	EN 593
Face to Face	EN 558
Flange Connection	ANSI 150
Test Standard	EN 12266-1

Hydrostatic Test

Pressure Rating	PN 10 / PN 16
Shell Test Pressure	1.5 / 2.4 Mpa
Seal Test Pressure	1.1 / 1.76 Mpa
Suitable Temperature	-20 to 180°C (PTFE)

Material

No	PART	MATERIAL
1	DOWN SHAFT	SS 316
2	LOCK PIN	SS 316
3	DOWN O-RING	VITON
4	BODY	CF8
5	SEAT	PTFE
6	DISC	CF8
7	UPPER SHAFT	SS 316
8	BUSHING (LONG)	PTFE
9	O-RING	VITON
10	BUSHING (SHORT)	PTFE
11	BESECT RING	SS 416
12	KEEPING RING	SPRING STEEL
13	NAME PLATE	ALUMINIUM
14	RIVET	ALUMINIUM
15	HAND LEVER	STAINLESS STEEL

Dimension in mm

DN	NPS	A	B	C	ØD	N-M	ØD1	R	H	ØW	M	N	P	Q	
50	2"	156	80	42.04	Ø120.6	4-5/8"	10UNC	Ø125	15	90	Ø120	45	155	100	108
65	2.5"	162	89	45.68	Ø139.7	4-5/8"	10UNC	Ø145	17	90	Ø120	45	155	100	108
80	3"	170	95	45.21	Ø152.4	4-5/8"	10UNC	Ø152.4	15	90	Ø120	45	155	100	108
100	4"	185	114	52.07	Ø190.5	8-5/8"	10UNC	Ø190.5	18	90	Ø120	45	155	100	108
125	5"	207	127	55.36	Ø215.9	8-3/4"	10UNC	Ø215.9	22	90	Ø120	45	155	100	108
150	6"	216	139	55.75	Ø241.3	8-3/4"	10UNC	Ø241.3	22	90	Ø120	45	155	100	108
200	8"	256	175	60.58	Ø298.4	8-3/4"	10UNC	Ø298.4	22	138	Ø200	63	190	157	144
250	10"	248	203	67.63	Ø361.9	12-7/8"	9UNC	Ø361.9	25	138	Ø200	63	190	157	144
300	12"	280	242	76.9	Ø431.8	12-7/8"	9UNC	Ø431.8	23	138	Ø200	63	190	157	144

The contents of this literature are for informative purposes only. Arita is not responsible for suitability or compatibility of these products in relation to system requirement. For specific requirements, consult Arita or its distributors. Arita reserves the right to change or modify product design without prior notice.