

20Kg/Cm² SLIP-ON WELDING STEEL PIPE FLANGES

JIS B2220-1984 (KSB 1503-1985)

TYPE A
NOMINAL SIZE 10-50mm

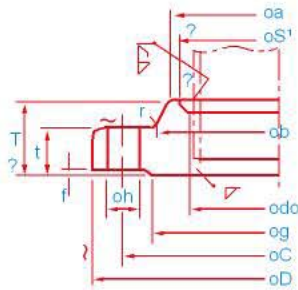

TYPE B
NOMINAL SIZE 10-50mm

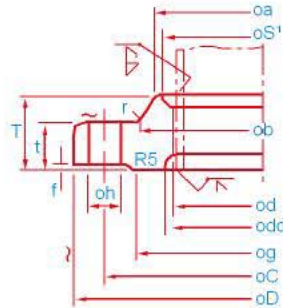

TYPE C
NOMINAL SIZE 65-600mm

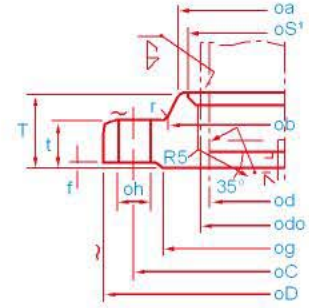

* The surface finish (-) is in the case of die forging

DIMENSIONS

Unit: mm

Nominal Bore of Flange	Outside Dia. of Flange D	Sectional Dimensions of Flange													Reference					Approx. Weight (kg)	
		Bolt Circle Dia. C	Dia. of Raised Face g	Inside Dia. of Flange do	Outside Dia. of Steel Pipe	t	T	Dia. of Hub		Radius r	f	d	Number of Bolt Holes	Hole Dia. h	Nominal Bolt Size	S'	m	S ²	n		l
								a	b												
10	90	65	46	17.8	17.3	14	20	30	32	4	1	-	4	15	M12	27	4	27	4	-	0.59
15	95	70	51	22.2	21.7	14	20	34	36	4	1	-	4	15	M12	31	4	31	4	-	0.65
20	100	75	56	27.7	27.2	16	22	40	42	4	1	-	4	15	M12	37	4	37	4	-	0.81
25	125	90	67	34.5	34.0	16	24	48	50	4	1	-	4	19	M16	44	4	44	4.5	-	1.29
32	135	100	76	43.2	42.7	18	26	56	60	5	2	-	4	19	M16	52	4	53	5	-	1.60
40	140	105	81	49.1	48.6	18	26	62	66	5	2	-	4	19	M16	58	4	59	5.5	-	1.69
50	155	120	96	61.1	60.5	18	26	76	80	5	2	-	8	19	M16	70	4	72	5.5	-	1.89
65	175	140	116	77.7	76.3	20	30	100	104	5	2	65.9	8	19	M16	94	6	-	-	6	2.60
80	200	160	132	90	89.1	22	34	113	117	6	2	78.1	8	23	M20	107	6	-	-	6	3.93
(90)	210	170	145	102.6	101.6	24	36	126	130	6	2	90.2	8	23	M20	120	6	-	-	6	4.50
100	225	185	160	115.4	114.3	24	36	138	142	6	2	102.3	8	23	M20	132	6	-	-	6	5.13
125	270	225	195	141.2	139.8	26	40	166	172	6	2	126.6	8	25	M20	160	7	-	-	6	8.30
150	305	260	230	166.6	165.2	28	42	196	202	6	2	151.0	12	25	M22	186	8	-	-	6	10.6
200	350	305	275	218.0	216.3	30	46	244	252	6	2	199.9	12	25	M22	273	9	-	-	6	13.3
250	430	380	345	269.5	267.4	34	52	304	312	6	2	248.8	12	27	M24	290	10	-	-	6	23.4
300	480	430	395	321.0	318.5	36	56	354	364	8	3	297.9	16	27	M24	345	11	-	-	6	27.7
350	540	480	440	358.1	355.6	40	62	398	408	8	3	333.4	16	33	M30 X 3	384	12	-	-	6	39.2
400	605	540	495	409.0	406.4	46	70	446	456	10	3	381.0	16	33	M30 X 3	437	13	-	-	7	54.2
450	675	605	560	460.0	457.2	48	78	504	514	10	3	431.8	20	33	M30 X 3	490	15	-	-	7	71.7
500	730	660	615	511.0	508.0	50	84	558	568	10	3	482.6	20	33	M30 X 3	544	16	-	-	7	86.2
(550)	795	720	670	562.0	558.8	52	90	612	622	10	3	533.4	20	39	M36 X 3	595	16	-	-	7	105
600	845	770	720	613.0	609.6	54	96	666	676	10	3	584.2	24	39	M36 X 3	646	18	-	-	7	119
*650	945	850	790	664	660.4	60	-	-	-	-	5	-	24	48	M45 X 3	-	-	-	-	-	-
*700	995	900	840	715	711.2	64	-	-	-	-	5	-	24	48	M45 X 3	-	-	-	-	-	-
*750	1080	970	900	766	762.0	68	-	-	-	-	5	-	24	56	M52 X 3	-	-	-	-	-	-
*800	1140	1030	960	817	812.8	72	-	-	-	-	5	-	24	56	M52 X 3	-	-	-	-	-	-
*850	1200	1090	1020	868	863.6	74	-	-	-	-	5	-	24	56	M52 X 3	-	-	-	-	-	-
*900	1250	1140	1070	919	914.4	76	-	-	-	-	5	-	28	56	M52 X 3	-	-	-	-	-	-