

## SLA Brass Series · 2/2-Way Piston Solenoid Valve · Normally Closed

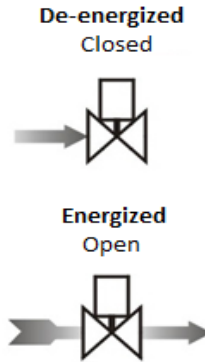

### Normally Closed



### DIMENSION

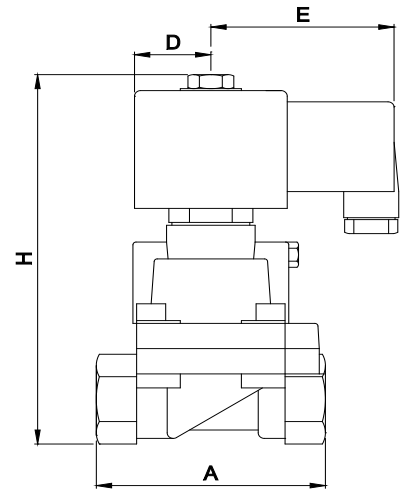

### Application:

Air, water, oil, Steam & etc.

### Specification:

Body : Brass  
 Sealing : Teflon  
 Pressure (M.O.P.D) : 0.5 ~ 25bar (Air, Water, Gas)  
 0.5 ~ 10bar

( Steam ) Media Temperature : Max 180 °C

Ambient temperature : 0 ~ 65 °C

Voltage : AC110, 240V 50/60Hz  
 : DC 24V

Power Consumption : AC-27VA(16W), DC-24W

Tolerance : +/- 10% ( AC ), +/-5% ( DC )

Coil : Din Standard, Metallic housing

### Feature:

- Can be installed in any position but the level condition to keep coil upside best for long life.
- Small size, high flow rate, widely use.
- Coil is design to turn in free direction.

### Unsuitable Fluid:

- Viscosity over 50 CST.
- Liquid when be heating, solid when cool.
- Do not use at corrosive fluid.

### Caution:

- Please clean up the inside of pipes before fitted.
- A strainer or filter has to be installed one meter away from the solenoid valve. Please install more than 60 mesh filter.
- Installation : flow as the arrow, solenoid vertical and upright direction

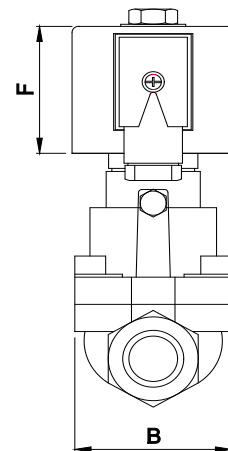

MODEL	CONNECTION	CV VALUE	ORIFICE (MM)	DIMENSION (mm)						
				A	B	H	D	E	F	
SLA-15	G1/2"	4.5	15	75	52	129	50	61	42.5	
SLA-20	G3/4"	9.0	20	85	60	141	50	61	42.5	
SLA-25	G1"	13	25	100	70	148	50	61	42.5	
SLA-32	G1.1/4"	26	35	120	90	168	50	61	42.5	
SLA-40	G1.1/2"	26	35	120	90	168	50	61	42.5	
SLA-50	G2"	48	50	150	110	190	50	61	42.5	

\*\*Note: All technical specification are without obligation!