

STAINLESS STEEL MINI BALL VALVE SCREWED END

Female to Female (F/F)

ART/BFF-XXX

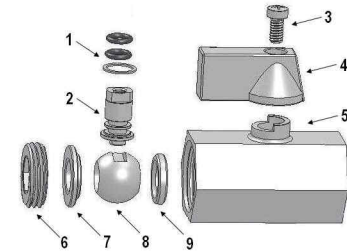
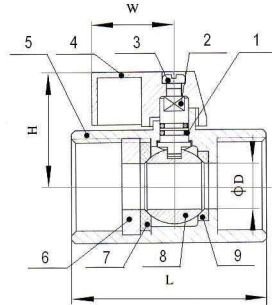

Male to Female (M/F)

ART/BMF-XXX

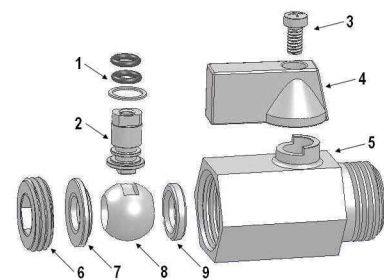
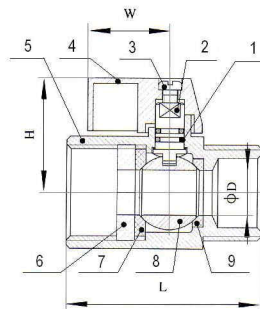

Male to Male (M/M)

ART/BMM-XXX

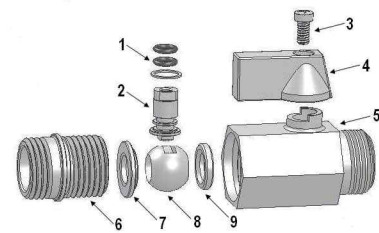
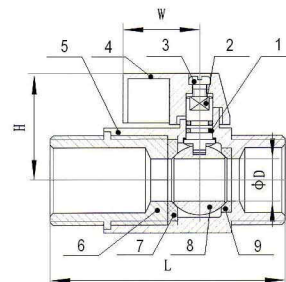

Technical Data

Dimension in mm

SIZES		D	H	W	L			WT. (g)		
DN	In.				F/F	M/F	M/M	F/F	M/F	M/M
6	1/4	7	26.5	22.8	42	42	50	98	78	100
10	3/8	7	26.5	22.8	42	42	50	91	75	100
15	1/2	9.2	28.3	22.8	46	46	58	120	115	150
20	3/4	12.5	31.5	22.8	54	54	70	208	188	250
25	1	34	34	22.8	65	65	83	295	280	350

Material

No.	PART	MATERIAL
1	O-RING	NBR
2	STEM	SUS 304
3	BOLT	SUS 304
4	HANDLE	ALUMINIUM
5	BODY	CF8
6	BODY CAP	CF8
7	SEAT RING A	PTFE
8	BALL	CF8
9	SEAT RING B	PTFE

Features

- * 1000PSI / PN63
- * Reduce Port
- * Investment Casting Body
- * Blow-out Proof Stem
- * Pipe thread in accordance : BSPT
- * Material : SS 304 / ASTM A351Gr-CF8 / DIN 1.4308