

# UNIJIN® LOW PRESSURE GAUGE

## Model : P421

P421 models are designed for non-corrosive environment with extremely sensitive and accurate. The brass chamber element is designed to measure low pressure, compound and vacuum for gaseous and dry air media. P421 model is complete with external zero adjustment screw at its back case for easy re-calibration when necessary.



## Standard Specification

### Dial Size

63mm(2.5"); 75mm(3")

### Scale Range (mbar, mmH<sub>2</sub>O)

0 ~ 6000 mmH<sub>2</sub>O

### Working Pressure

75% of Full Scale

### Zero Adjustment

At Back Case (75mm)

Inside window (63mm)

### Accuracy

63mm(± 2.5%); 75mm(± 2.5%) of Full Scale

### Working Temperature

Ambient : -20 ~ 60°C

Process : -20 ~ 60°C

### Material

Case & Cover : Chrome Plated Brass

Window : Glass (75mm); Acrylic(snap-on)(63mm)

Movement : Brass

Element : Brass

Capsule Type : Brass

Connection : Chrome Plated Brass

## Pressure Gauge Ordering Information

### Model

P421

### Mounting Type

A: Direct bottom connection

### Dial Size

63mm; 75mm

### Scale Range

refer table

### Connection Type

1/4"; 3/8" BSPT

### Example of Order

#### Model

P421

#### Mounting Type

(A)

#### Dial Size

75mm

#### Scale Range

0 ~ 300mbar

#### Connection

3/8" BSPT

## Basic Dimensions

CODE A

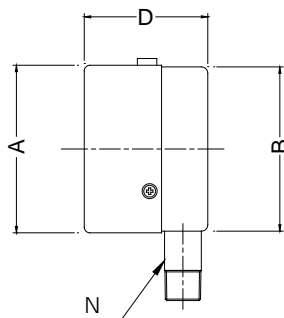
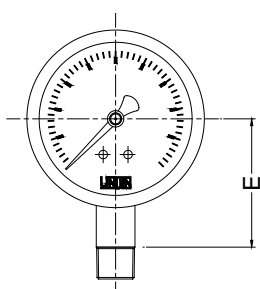

### A: Direct bottom connection

Unit : mm

	ø 63	ø 75
A	67.0	78.5
B	66.0	76.5
D	47.0	57.0
E	42.0	55.0
N	14.0	17.0