



UNIMECH GROUP, MALAYSIA



A MEMBER OF UNIMECH GROUP, MALAYSIA

## CAST IRON SWING CHECK VALVE FLANGED END PN 16

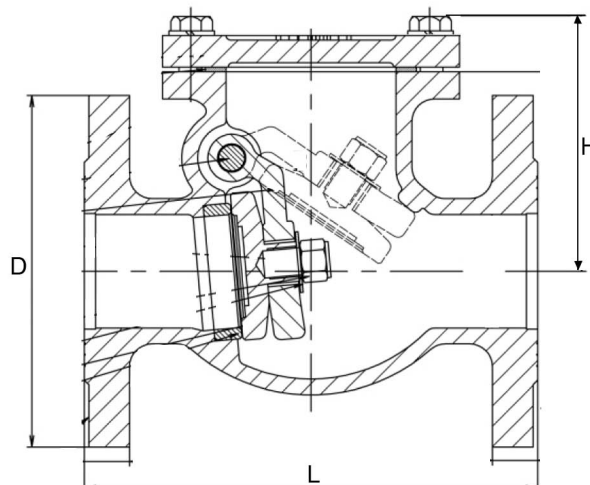

### Features :

Face to Face is according to BS5150/5163

Flange drilled is according to BS4504

Working Pressure : PN 16

Test Pressure Shell : 24 kgf/cm<sup>2</sup>Seat : 17.6 kgf/cm<sup>2</sup>

### Technical Data

#### Material

No.	PART	MATERIAL
1	BODY	CAST IRON (A126)
2	BONNET	CAST IRON (A126)
3	DISC	CAST IRON (A126)
4	SEAT RING	CAST BRONZE / STAINLESS STEEL (B62)
5	INGE PIN	STAINLESS STEEL (SS304)
6	DRAIN PLUG	CARBON STEEL (SS41)

#### Dimension in mm

SIZES		L	H	D
DN	in.			
40	1.1/2"	190	100	140
50	2"	203	105	155
65	2.1/2"	220	115	175
80	3"	240	140	185
100	4"	292	155	210
125	5"	330	170	250
150	6"	365	203	280
200	8"	495	246	330
250	10"	622	283	400
300	12"	698	330	445