



UNIMECH GROUP, MALAYSIA



A MEMBER OF UNIMECH GROUP, MALAYSIA

## **GATE VALVE FLANGED END CLASS 100 BS TABLE E**



Arita Cast Iron Gate Valve design is conform to BS 3464. The design structure of the valve gives ample tolerance to its designated working pressure. The wedge and seats are precisely machined to prove good sealing. The operating movement of the wedge is guided to insure good alignment for good sealing and operation torque. In the fully opening position, the wedge is clear from the port to allow smooth flow without obstruction with minimal pressure drop. The graphite packing gives good sealing to eliminate leaking around the stem. The handwheel design provide good gripping and operating leverage. The valves are suitable for general industrial facilities in water and oil.

## Dimension in mm (Table E Flanged End)

SIZES		Bore	L	H	D	Cv	WT.
DN	in.	Diameter					(KG)
50	2	50	151	284	150	26	14.2
65	2.1/2	65	165	310	150	50	16.8
80	3	80	167	365	180	94	21.4
100	4	100	172	382	200	160	29.0
125	5	125	193	454	245	260	42.0
150	6	150	213	495	245	480	57.0
200	8	200	246	630	300	750	94.6
250	10	250	280	725	300	1300	147.0
300	12	300	305	816	400	2300	

Note : Cv = US Gallon per minutes

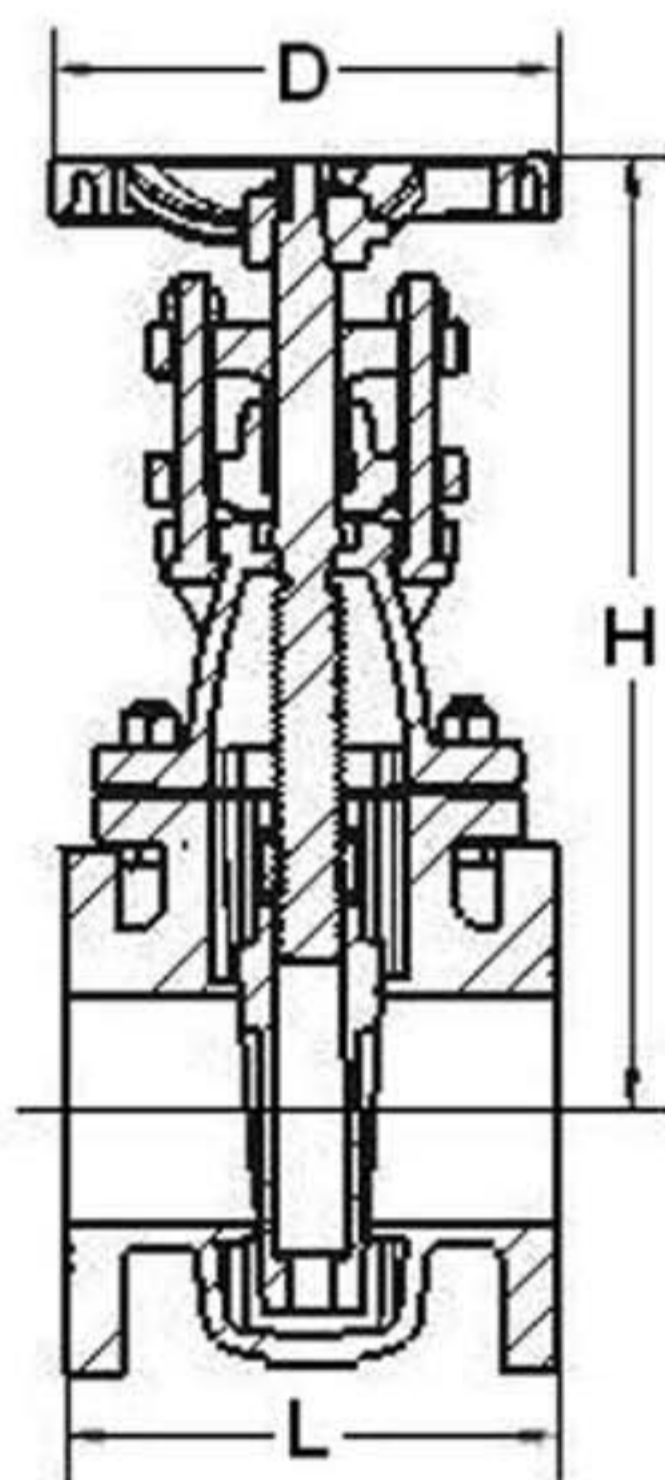

## Pressure Test

Hydrostatic Test		Working Pressure
Body	15 kgf/cm <sup>2</sup>	10kgf/cm <sup>2</sup>
Seat	11 kgf/cm <sup>2</sup>	

## Pressure - Temperature

Temperature °C	-10 ~ 120	150	180	200
Pressure Mpa (kgf/cm <sup>2</sup> )	0.98 (10.0)	0.88 (9.0)	0.83 (8.5)	0.78 (8.0)

\* Note: For non-shock water, at 120°C, the allowable pressure is 1.37 Mpa (14 kgf/cm<sup>2</sup>)

## Technical Data

## Material

No.	PART	QTY.	MATERIAL
1	BODY	1	FC 200
2	BONNET	1	FC 200
3	DISC	1	FC 200
4	BONNET GASKET	1	Graphite / NBR
5	BOTTOM GLAND	1	FC 200
6	TOP GLAND	1	FC 200
7	GLAND PACKING	1	Graphite
8	GLAND SEAL	1	Graphite / NBR
9	STEM	1	SUS 420
10	HANDWHEEL	1	FC 200
11	STEM NUT	1	Brass
12	GLAND CAP SCREW	2	Mild Steel (Black finished)
13	BONNET CAP SCREW	4-10	Mild Steel (Black finished)
14	GLAND NUT / BONNET NUT	7-13	Mild Steel (Black finished)
15	STEM WASHER	1	Chromed Mild Steel

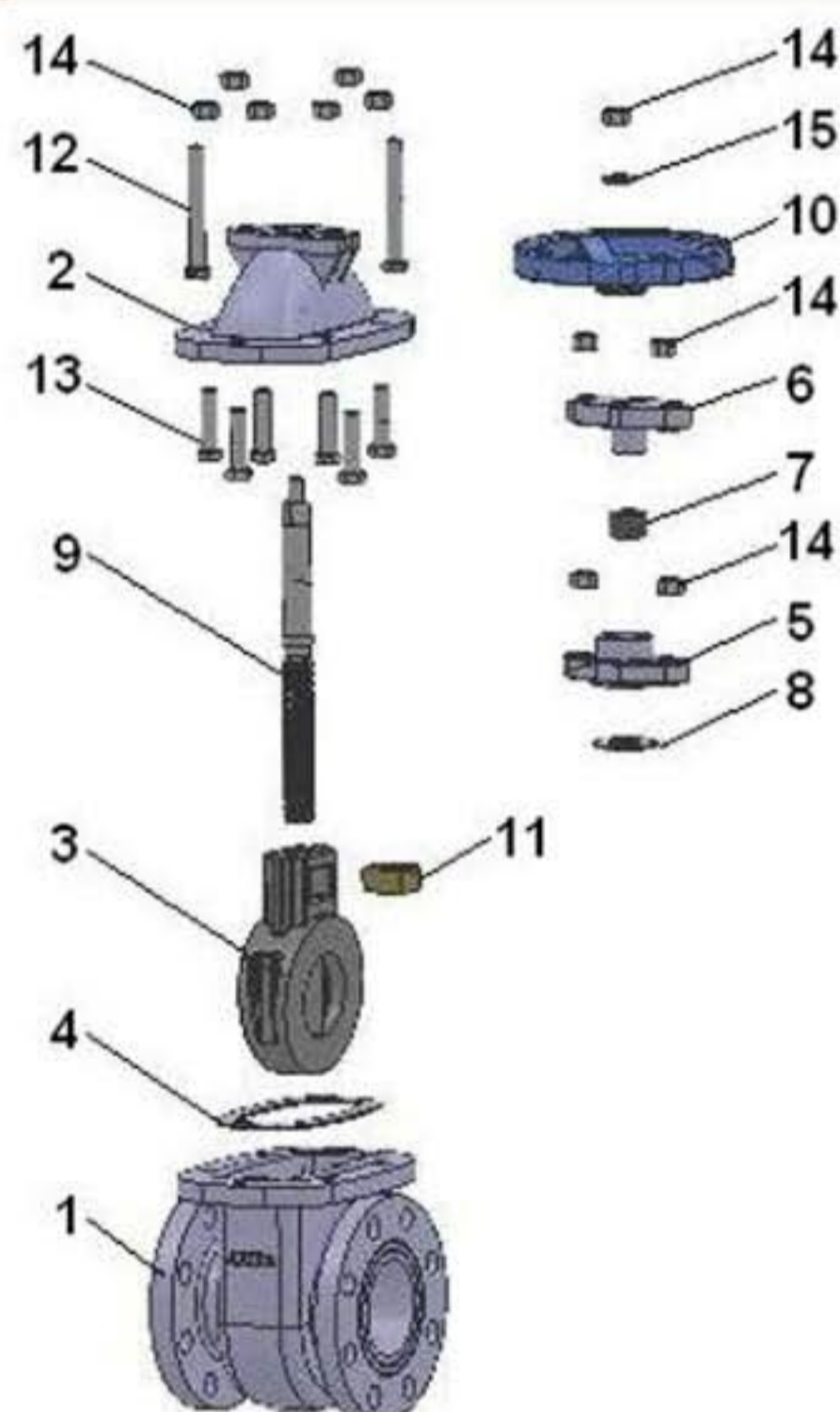

## Design Standard:

BS 3464	Design Standard
BS 3464	Face to Face Distance
BS Table E	Flanged Ends

